

FORM NO 1.

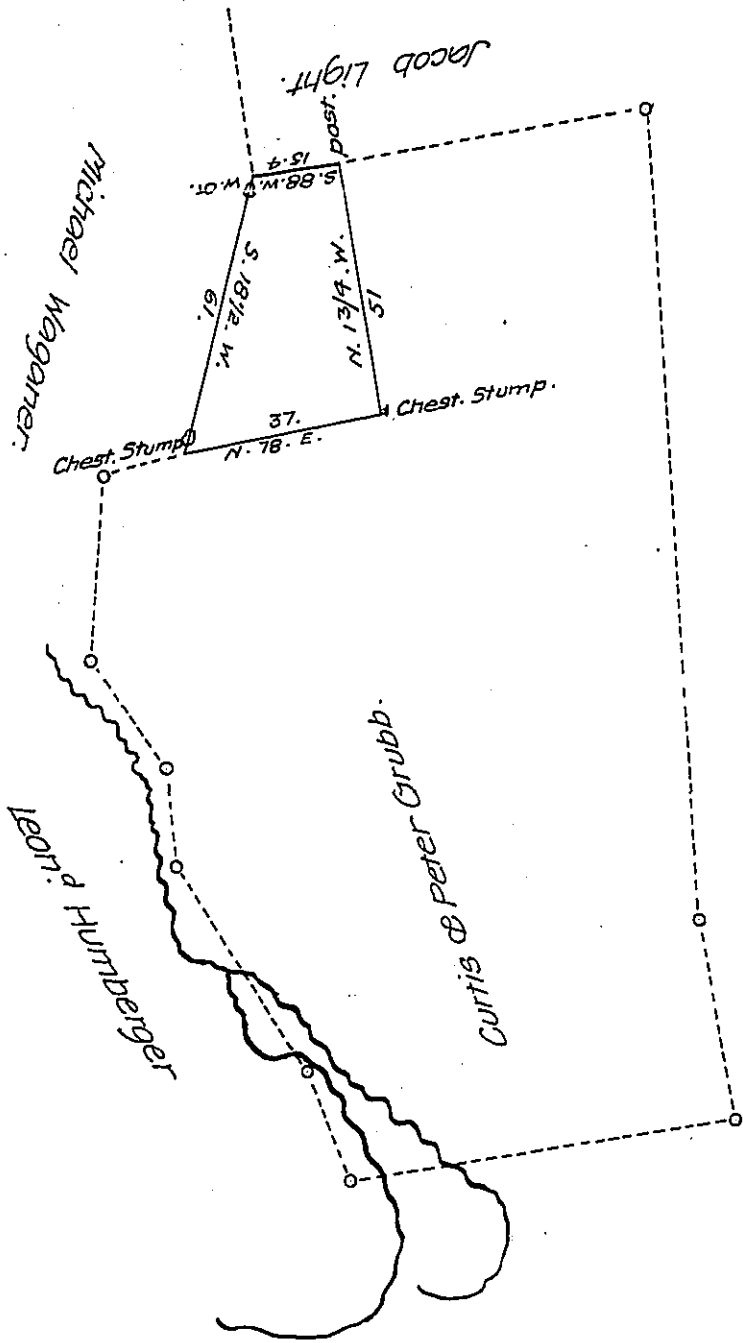

The above described tract of land Situate in Lebanon Township in the County of Lebanon, Contain^g Eight acres & allow. It being part of 137⁹³ 88 per. & allow. which by Warrant dated the 23rd. day of June 1768 was Granted to Curtis & Peter Grubb. Survey^d to Jacob Umberger the 18 of Oct. 1832.

Tob^s Kreider
Dep. Surveyor.

- To Jacob Spangler Esq.
Surveyor General. Penn^a

IN TESTIMONY that the above is a copy of the original remaining on file in the Department of Internal Affairs of Pennsylvania, made conformably to an Act of Assembly approved the 16th day of February, 1833, I have hereunto set my Hand and caused the Seal of said Department to be affixed at Harrisburg, this twenty sixth day of October 1907.

Henry Houder
Secretary of Internal Affairs.